

Examples of my work

Table of Contents

1. Overview & Domains
2. Platform & Internal Products – Case Study
3. Market Stats – Product Walkthrough
4. Identity Privacy & Access Management – Case Study
5. Monetization & Operational Workflows – Case Study
6. Delivery Artifacts & Execution Evidence

Overview & Domains

This portfolio presents selected product work by **Niara Mamontova, a Product Manager** with experience across platform, internal, and data products in both enterprise and consumer environments.

Domains: Enterprise & B2B/B2C SaaS · FinTech & Payments · Identity & Privacy · Data & Analytics · Internal Platforms & Tooling

Platform & Internal Product Ownership

Linecity.com – End-to-end delivery ownership via Jira · Consumer-facing platform screen

Projects / LC Product / LCP board

Kanban board

High Priority High value Only My Issues

NEW (CREATED BY DI)	IN PROGRESS	IN TEAM (SPRINT)
<p>Page for the Linecity Blog</p> <p>3</p> <p>LCP-130</p>	<p>[Dashboard, Analytics, Listings] show listing activity</p> <p>Dashboard</p> <p>LCP-112</p>	<p>Do not sync</p> <p>4</p>
<p>Change Other Park View to Park Views</p> <p>3</p> <p>LCP-129</p>	<p>UI for Agents Team</p> <p>1</p> <p>LCP-114</p>	<p>Report an in</p> <p>3</p>
<p>Change layout of Neighborhood on Listing Detail</p> <p>3</p>	<p>Static Pages</p> <p>3</p>	<p>User Profile</p> <p>3</p>

linecity BUY RENT AGENTS BUILDINGS Market Your Place Sign up Log In >

Listed by Douglas Elliman on July 1, 2018 86 Days on the market 1.2K Views 8 Saves

NEW THIS WEEK

One Beacon Court
📍 **40 Mercer St, Apt. 37**
Cross Streets: 11th Avenue & 12th Avenue | Clinton, Manhattan

5 🏠 2 🛏 2 🚿 4,600 [SF] Condo 🏢

\$8,900,000

	Monthly Charges	Price Per SF
Common Charges	\$3,456	PSF
RE Taxes	\$3,115	\$1,400

LISTING FEATURES

☀️ Southern Exposure 🛠 Renovated ☀️ Southern Exposure

CONTACT AGENT

- Andrea Wells**
Douglas Elliman
[Call Agent](#)
- Michael Kafka**
Douglas Elliman
[Call Agent](#)
- Abigail Perlman**
Douglas Elliman
[Call Agent](#)
- Andrea Wells**
Douglas Elliman
[Call Agent](#)

3 OPEN HOUSES

Sunday, February 18, 2018
12:00 - 1:00PM

Market Stats – Product Walkthrough

OLR.com – Market Stats is an internal analytics product providing consolidated market insights for Business.

The video demonstrates the final production user walkthrough of the tool, designed and delivered end-to-end by me and my team.

▶ Click to watch the product walkthrough

VIDEO TUTORIAL



MARKET STAT REPORTS TOUR

MARKET STATISTICAL REPORT

Identity Privacy & Access Management

Namecheap.com – 2FA workflow for an enterprise Auth-system ·
 2FA UI execution · QA Validation and error-handling matrix

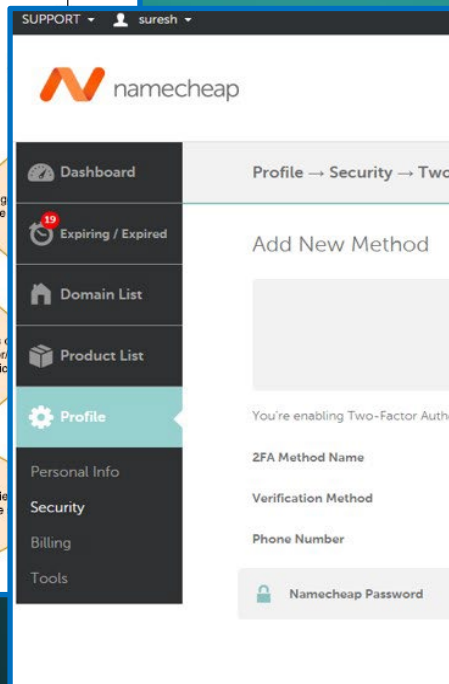
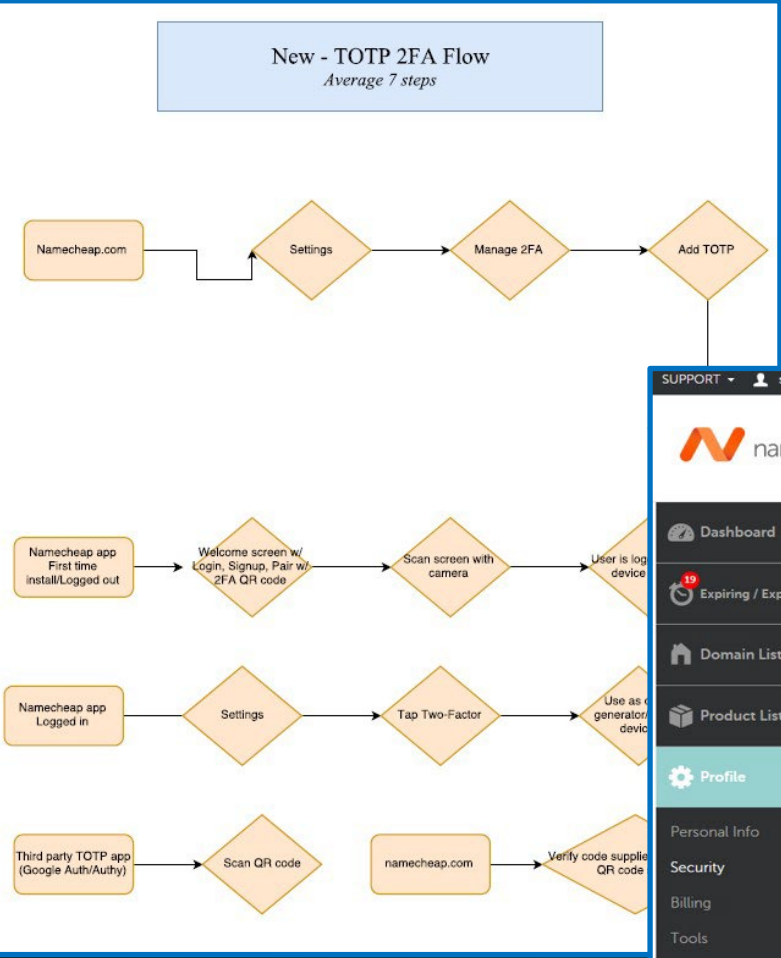

1	Error scenarios	Legacy System: monolith	Questions	UX FINAL COPY	Note
2					
3	Username validations				
4	Username contains restricted	https://www.screencast.com/t/BaQEJGij	Is it OK to use the	"Your username must contain only letters (a-z)"	We should change
5	Username already exists	https://www.screencast.com/t/McmLxAown	Should we leave	Title: Validation error.	
6	Empty Username	https://www.screencast.com/t/e7GX9KFGifs	Should we leave	"A valid username is required"	in UX review
7	Password validations				
8	Password value is less than 8	https://www.screencast.com/t/UsdHj9kEWc	We will use the UX	"Your password must contain at least 8"	We should
9	Empty password	https://www.screencast.com/t/Ofkl369Y3uYM	Should we leave	Link: https://screencast.com/t/dlBINese	The behavior
10	Passwords starts or ends with 'space'	https://www.screencast.com/t/6wLrwSf1r	Should we leave	Link: https://screencast.com/t/dlBINese	
11	First Name / Last Name validations				
12	First/Last Name contains restricted	https://www.screencast.com/t/bfSSOf1oOx	What message	"No special characters allowed"	
13	Empty First Name	https://www.screencast.com/t/dPUBJtT	Should we leave	"A valid first name is required"	The behavior
14	Empty Last Name	https://www.screencast.com/t/0jDxiU38s	Should we leave	"A valid last name is required"	The behavior
15	Email Address validations				
16	Email Address has invalid format	https://www.screencast.com/t/jm0XnqnGaaN3	Should we leave	"A valid email address is required"	The behavior
17	Email Address is not real	https://www.screencast.com/t/PMcvBEgwiM	Should we leave	"A valid email address is required"	The behavior
18	Email Address already exists	https://www.screencast.com/t/cVsneVmfPyC	Should we leave	Title: Validation error.	Same behavior
19	Empty Email Address	https://www.screencast.com/t/Tl4tkDBdvGgM	Should we leave	"A valid email address is required"	The behavior
20	Wrong Characters error on Sign-up			https://www.screencast.com/t/U7BtvHvjij1	
21					

Monetization & Operational Workflows

Linecity.com – Expert Subscription Flow

Workflow diagram illustrating the Expert onboarding flow

• UI mockup of the “Make me an Expert” feature • Checkout UI for Expert subscription

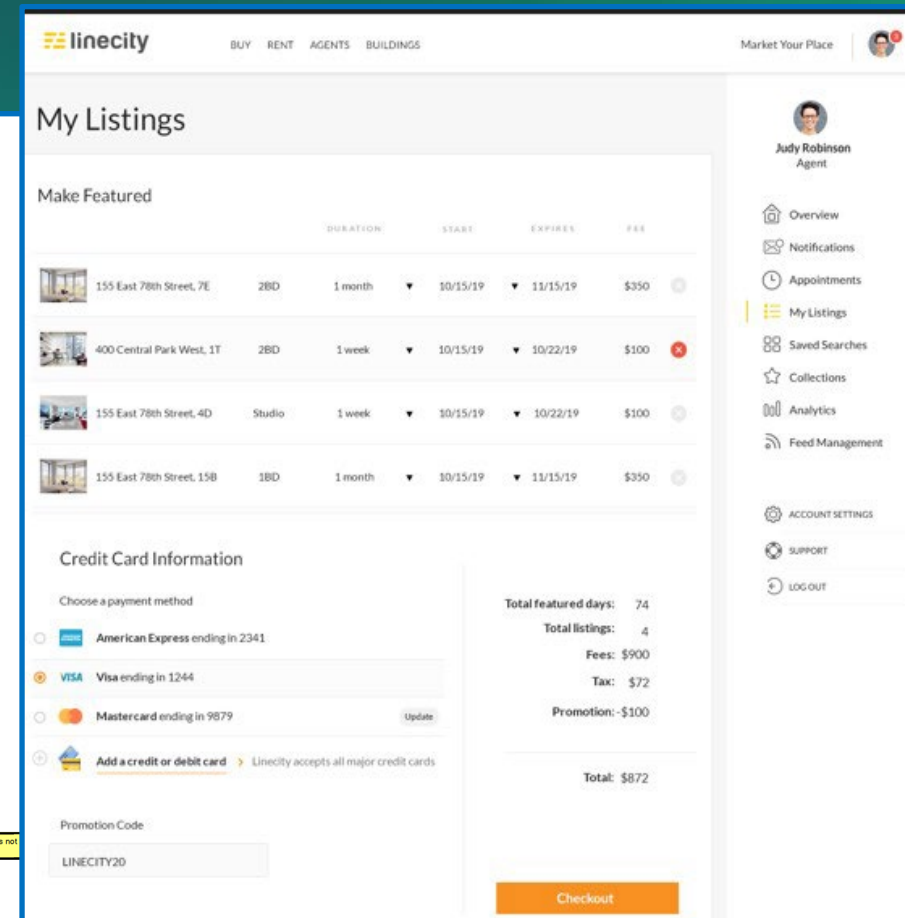
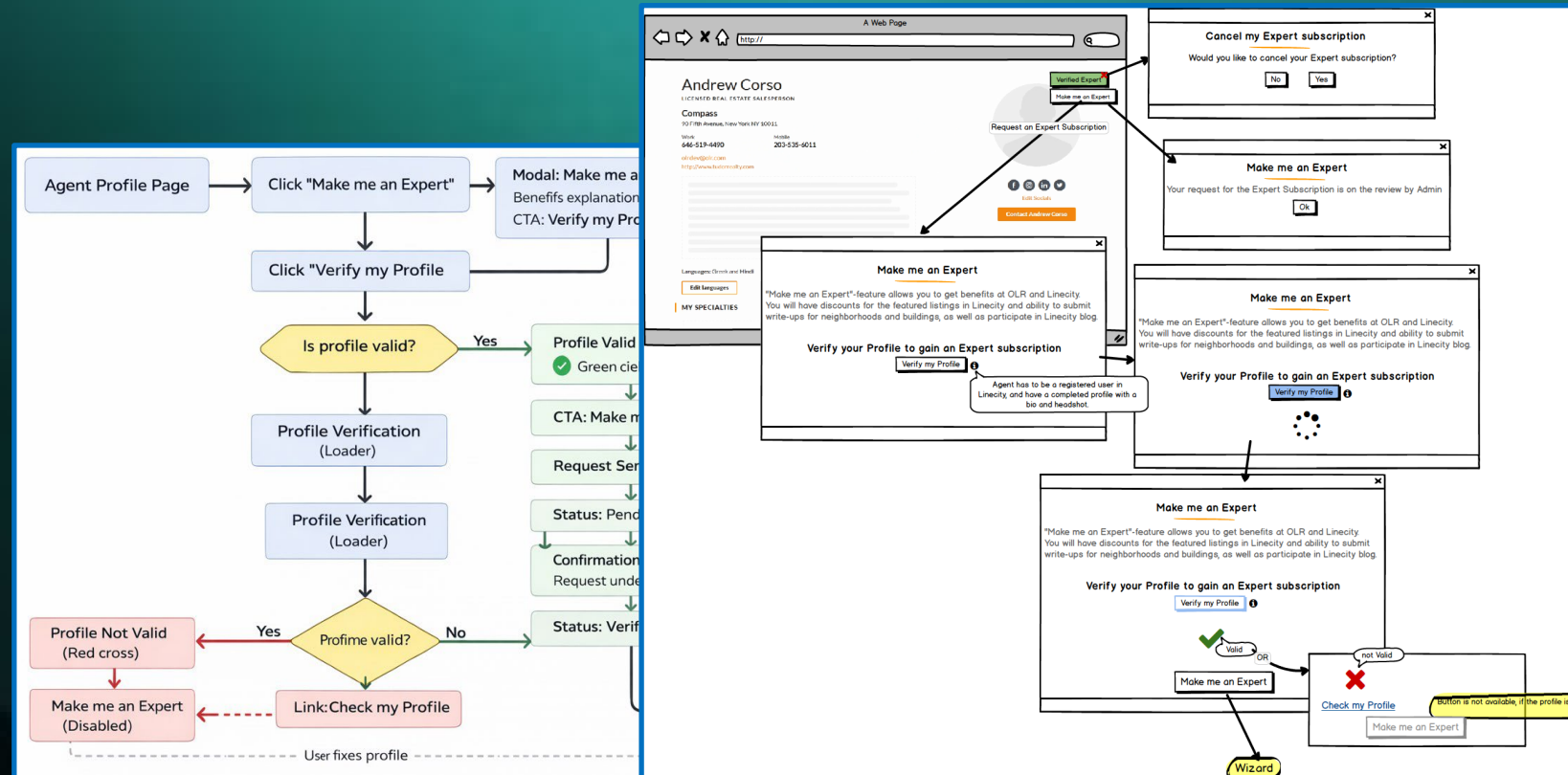

Delivery Artifacts & Execution Evidence

Technovation (via SoftServe) – examples of product ownership artifacts created and used during delivery:

Meeting Minutes • Epic Scope Definition

Meeting theme: Attendance tracking system (key tag scanning system)

Date of meeting: 17.11.2011

Participants: XXXX

Agenda:

1. Discuss what was already done in attendance tracking direction
2. What should be done to bring current system to production;
3. What is the best way to integrate with "Blueprint";
4. Answers to prepared questions

Results:

During the meeting we got answers to prepared questions

I. Iridescent team wants to implement updated application to "Attendance tracking system". The main feature of it are:

1. Existed application is not accessible to Internet and web browser. Iridescent. There are 50 laptops with the installed application.
2. All attendee will have a key tag. There are five categories: students, volunteers, administrators. The categories may be included in these attendee in person-type information.
3. A user may have only one active key tag, if user lost it, there is a possibility to replace old key tag with new one, with the help of administrator. Besides student's information, key tag should contain information about Guardian may become: adult sister, brother, tutor, and so on.
5. A key tag has only one user's profile
6. There are free registration forms, that filled manually. Information manually are entered into the system and associated with key tag.
7. All key tags (with bar codes) are preprinted and their list should be a list of unused key tags imported into the system;
8. For now key tag system is used only by 50 families
9. Registration process of key tag: User should give his contact information for key tag obtain. Only real users (with a phone number) are registered manually by administrator. When user is registered, he is given a key tag. Not all registered users in curiosity may have a key tag.
10. Key tag information is stored in MySQL database
11. User may participate in Program without key tag (if they are not at summer camps. So some programs requires key tag for visitors;
12. Administrator schedules a program to users in key tag system
13. Programs are free of charge, camps are not.

II. New requirements to application:

ID	Module (epic) name	User story (Requirement)	Priority
US001	1.User profile and login	As a user I want to be able to register and create my profile in order to be provided proper permissions by the system and to be identified by professionals and peers (S-2).	Must
US003	1.User profile and login	As a new user I'd like to state my will to be a contributor and provide the relevant information about my experience in order to get access to the professional space.	Should
US004	1.User profile and login	As administrator I would like to view all applications of contributors for Professional space access in order to authorize or decline requests.	Should
US007	2.Learning space	As a student I want to rate the viewed content in order to show what is more interesting and valuable for me.	Nice to have
US008	3.Sharing space	As a student I need to be able to film my experiments and POST THESE TO SHARING SPACE, also share the results with my peers and professionals in order to get feedback and improve skill/results(S-2).	Must
US009	3.Sharing space	As a professional/assessor I need to view the experiment records (reports) shared by students and relevant to the topic of my interest/related to content submitted by me, in order to provide feedback and assess the results.	Must
US010	4. Professional space	As a professional I need to view and publish content (curriculum) to the professional space, in order to share and refine with other professionals.	Should
US016	5.Mobile access to learning and sharing spaces	As a student I want to view content from Learning space on my mobile device.	Should
US017	5.Mobile access to learning and sharing spaces	As a student I want to capture video on my mobile device and upload it to sharing space under my ID in order to use it conveniently without dragging my laptop everywhere.	Must
US019	9.Social Networking	As a user I want to network (connect) with other users and get notifications about their updates in order to be informed as a part of peer community and socialize while learning/teaching (may be reached by use of external services integration)	Must
US020	10.Structuring activities/groups	As a professional/assessor I want to get updates about new uploads in groups to which I am subscribed in order to review and provide feedback/assessment to experiments of users who are awaiting response.	Should
US022	6.Security	As a parent I want the user profiles and sharing space of portfolio (system) to be not accessible for not confirmed users (unregistered or not activated)	Must
...

Thank you for your time!